

# Bi2 DUCTED

Terminali canalizzabili

Ripresa aria posteriore

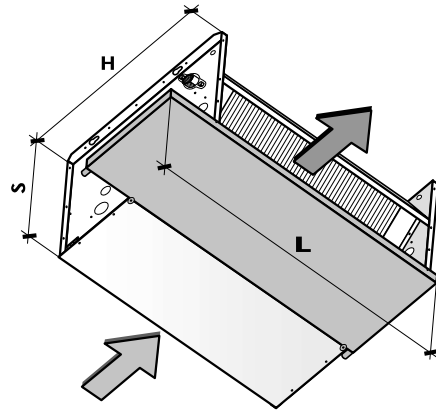
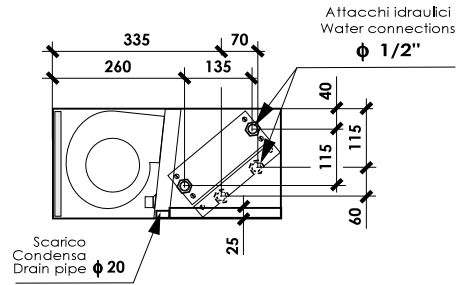
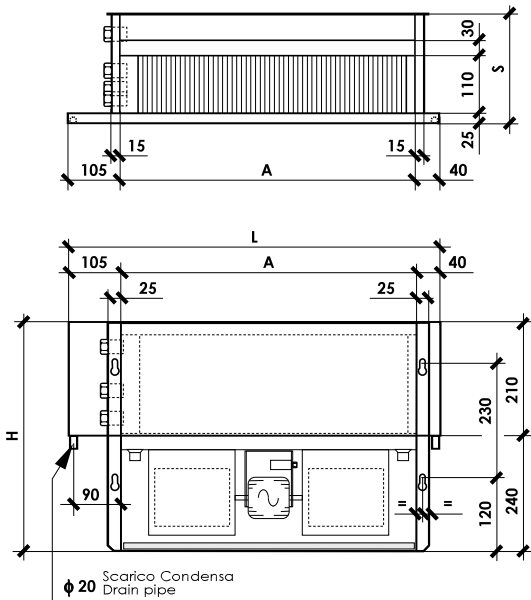

Taglia - Size			220	320	420	520	620	720	820	1020	1120	1220
Dimensioni principali Main dimensions	L	mm	545	745	745	945	945	1145	1145	1345	1545	1545
	H	mm	450	450	450	450	450	450	450	450	450	450
	S	mm	215	215	215	215	215	215	215	215	215	215
	A	mm	400	600	600	800	800	1.000	1.000	1.200	1.400	1.400
N° Motori			1	1	1	1	1	1	1	1	1	1
N° Ventilatori			1	1	1	2	2	2	2	2	3	3
Batteria	Contenuto acqua - Water volume (l)		0,70	0,99	1,01	1,30	1,31	1,60	1,62	1,92	2,21	2,23
caldo/freddo	Ranghi - Rows		3R	3R	3R	3R	3R	3R	3R	3R	3R	3R
Heating/cooling coil	DN(*)		1/2" F	1/2" F	1/2" F	1/2" F	1/2" F	1/2" F	1/2" F	1/2" F	1/2" F	1/2" F
Scarico condensa - Drain pipe	φ (mm)		20	20	20	20	20	20	20	20	20	20
Peso netto	2 Tubi/Pipe	Kg	11,5	14,3	15,1	20,6	21,6	23,5	25,0	28,1	30,1	33,6
Net weight												

DN(\*) = Diametro nominale, F = Attacchi idraulici batteria Gas femmina

▪ (\*) kg = Peso netto (solo unità, escluso imballo)

DN(\*) = Nominal diameter, F = Female gas water coil connections

▪ (\*) kg = Net weight (unit only, excluding packaging)

# Bi2 DUCTED

## Terminali canalizzabili

### Ripresa aria frontale

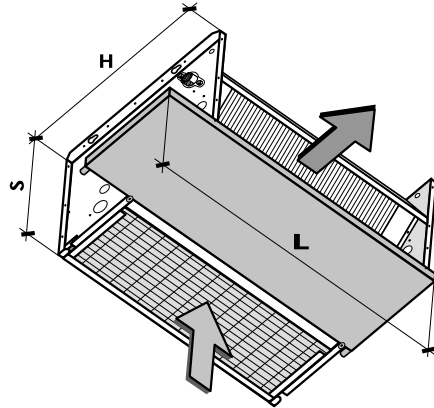
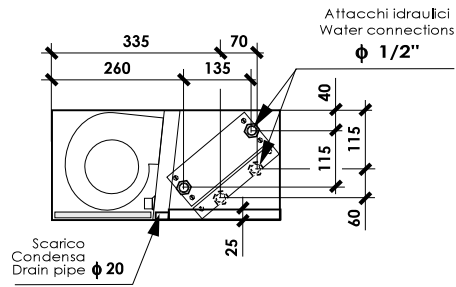
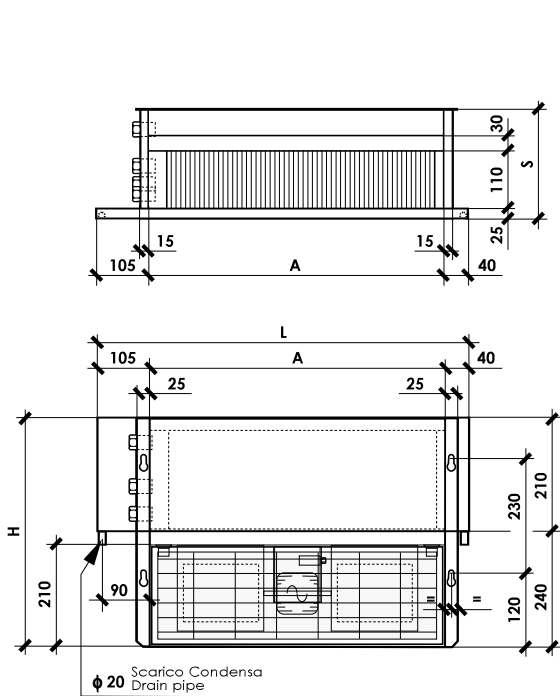

Taglia - Size			220	320	420	520	620	720	820	1020	1120	1220
Dimensioni principali Main dimensions	L	mm	545	745	745	945	945	1145	1145	1345	1545	1545
	H	mm	450	450	450	450	450	450	450	450	450	450
	S	mm	215	215	215	215	215	215	215	215	215	215
	A	mm	400	600	600	800	800	1.000	1.000	1.200	1.400	1.400
N° Motori			1	1	1	1	1	1	1	1	1	1
N° Ventilatori			1	1	1	2	2	2	2	2	3	3
Batteria	Contenuto acqua - Water volume (l)		0,70	0,99	1,01	1,30	1,31	1,60	1,62	1,92	2,21	2,23
caldo/freddo	Ranghi - Rows		3R	3R	3R	3R	3R	3R	3R	3R	3R	3R
Heating/cooling coil	DN(*)		1/2" F	1/2" F	1/2" F	1/2" F	1/2" F	1/2" F	1/2" F	1/2" F	1/2" F	1/2" F
Scarico condensa - Drain pipe	φ (mm)		20	20	20	20	20	20	20	20	20	20
Peso netto	2 Tubi/Pipe	Kg	11,4	14,2	15,0	20,5	21,5	23,3	24,8	27,9	29,9	33,4
Net weight												

DN(\*) = Diametro nominale, F = Atacchi idraulici batteria Gas femmina

▪ (\*) kg = Peso netto (solo unità, escluso imballo)

DN(\*) = Nominal diameter, F = Female gas water coil connections

▪ (\*) kg = Net weight (unit only, excluding packaging)